

## MODULAR CABINETS AZ.HY MODEL



Cabinet made of AISI 304 stainless steel (Wnr 1.4301) with internal plate made of FeZn

Mounting plate with rollers on tracks, depth adjustable and removable from the side

Internal hinges

Drilled reinforcement for door with joint angle for grounding

Wide range of customer-specific adaptations

Silicone sealing

The positioning of multiple structures must be defined during the order process

Protection code: IP 66 IK07 - IP69K

### TECHNICAL DESCRIPTION

<b>Type of steel:</b> AISI 304 (Wnr 1.4301) Scotch-brite
<b>Thickness:</b> 1,5 mm (0.06")
<b>Door:</b> windowless
<b>Door fixing:</b> hinges
<b>Door opening:</b> 95°
<b>Frame:</b> stiffened, provided for the following widths: 600/800/1000/1200 mm
<b>Sides:</b> screwed
<b>Top:</b> inclined by 30°, door extended out
<b>Gasket:</b> FDA-approved silicone
<b>Mounting plate:</b> included, made of FeZn 25/10
<b>Locking system:</b> Two hygienic locks with rods system, for doors L=1000: two additional central locks

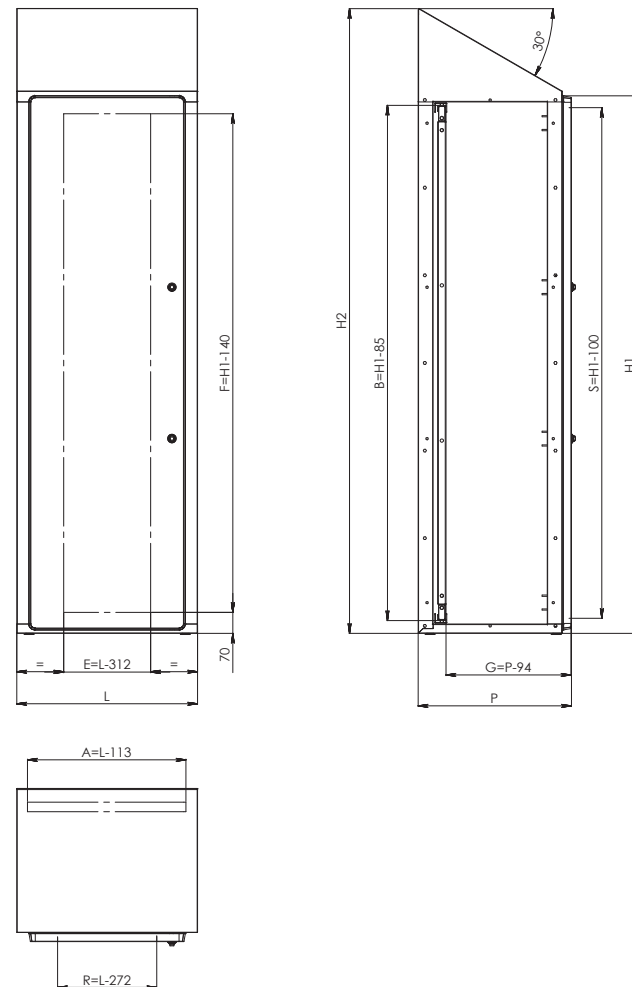

### TECHNICAL DATA

Mounting plate	W-113 mm (4.45"), H1-85 mm (3.35")
Door drill size	W-312 mm (12.28"), H1-140 mm (5.51")
Usable depth	D-94 mm (3.70")



HYGIENIC  
AZ.HY MODEL  
MODULAR CABINET

INTEGRATED ROOF  
INCLINED BY 30°

EXTERNAL SILICONE  
SEALING REMOVABLE  
ACCORDING TO FDA

### CUSTOMIZATION POSSIBILITIES

**Dimensions:** adaptable on request\*

**Material:** AISI 316L (Wnr 1.4404)

\* to be verified during order process

### ON REQUEST

Stainless steel mounting plate

Solid bottom plinth with adjustable feet, mechanically fixed to the cabinet and provided with silicone

Sidewalls

Flat cable gland plate and double cable gland plate combinable with the plinth

### STANDARD CABINET CONSTRUCTION

Model structure

Solid door

Solid floor

Standard mounting plate made of FeZn 25/10



## AZ.HY SUMMARY TABLE

Model	Code	Cabinet external dimensions								No. doors	Kg*	m³	No. hinges	Internal mounting plate dimensions		Internal mounting plate dimensions		Dimensions of door reinforcement frame				Door drill size				Usable depth with internal mounting plate on rollers		Certification				in stock*
		W		H 1		H 2		D						A		B		R		S		E		F		G		IP 66 IK07	IP69K	DGVU	UL type 1,12,13,4,4x	
		mm	in.	mm	in.	mm	in.	mm	in.					mm	in.	mm	in.	mm	in.	mm	in.	mm	in.	mm	in.	mm	in.					
AZ.HY 40 180 40	013290010	402	15.83	1800	70.87	2022	79.61	410	16.14	1	65	0,3499	4	289	11.38	1715	67.52	N.P.	N.P.	N.P.	N.P.	210	8.27	1740	68.50	316	12.44	on request	on request	on request	on request	NO
AZ.HY 40 180 50	013290060	402	15.83	1800	70.87	2080	81.89	510	20.08	1	66	0,4478	4	289	11.38	1715	67.52	N.P.	N.P.	N.P.	N.P.	210	8.27	1740	68.50	416	16.38	on request	on request	on request	on request	NO
AZ.HY 40 180 60	013290110	402	15.83	1800	70.87	2138	84.17	610	24.02	1	68	0,5505	4	289	11.38	1715	67.52	N.P.	N.P.	N.P.	N.P.	210	8.27	1740	68.50	516	20.31	on request	on request	on request	on request	NO
AZ.HY 40 200 40	013290160	402	15.83	2000	78.74	2222	87.48	410	16.14	1	71	0,3845	4	289	11.38	1915	75.39	N.P.	N.P.	N.P.	N.P.	210	8.27	1740	68.50	316	12.44	on request	on request	on request	on request	NO
AZ.HY 40 200 50	013290210	402	15.83	2000	78.74	2280	89.76	510	20.08	1	72	0,4908	4	289	11.38	1915	75.39	N.P.	N.P.	N.P.	N.P.	210	8.27	1740	68.50	416	16.38	on request	on request	on request	on request	NO
AZ.HY 40 200 60	013290260	402	15.83	2000	78.74	2338	92.05	610	24.02	1	74	0,602	4	289	11.38	1915	75.39	N.P.	N.P.	N.P.	N.P.	210	8.27	1740	68.50	516	20.31	on request	on request	on request	on request	NO
AZ.HY 60 180 40	013290020	602	23.7	1800	70.87	2022	79.61	410	16.14	1	89	0,524	4	489	19.25	1715	67.52	330	12.99	1700	66.93	290	11.42	1660	65.35	316	12.44	on request	on request	on request	on request	NO
AZ.HY 60 180 50	013290070	602	23.7	1800	70.87	2080	81.89	510	20.08	1	91	0,6705	4	489	19.25	1715	67.52	330	12.99	1700	66.93	290	11.42	1660	65.35	416	16.38	on request	on request	on request	on request	NO
AZ.HY 60 180 60	013290120	602	23.7	1800	70.87	2138	84.17	610	24.02	1	93	0,8244	4	489	19.25	1715	67.52	330	12.99	1700	66.93	290	11.42	1660	65.35	516	20.31	on request	on request	on request	on request	NO
AZ.HY 60 200 40	013290170	602	23.7	2000	78.74	2222	87.48	410	16.14	1	97	0,5759	4	489	19.25	1915	75.39	330	12.99	1900	74.8	290	11.42	1860	73.23	316	12.44	on request	on request	on request	on request	NO
AZ.HY 60 200 50	013290220	602	23.7	2000	78.74	2280	89.76	510	20.08	1	100	0,735	4	489	19.25	1915	75.39	330	12.99	1900	74.8	290	11.42	1860	73.23	416	16.38	on request	on request	on request	on request	NO
AZ.HY 60 200 60	013290270	602	23.7	2000	78.74	2338	92.05	610	24.02	1	102	0,9015	4	489	19.25	1915	75.39	330	12.99	1900	74.8	290	11.42	1860	73.23	516	20.31	on request	on request	on request	on request	NO
AZ.HY 80 180 40	013290030	802	31.57	1800	70.87	2022	79.61	410	16.14	1	109	0,6981	4	689	27.13	1715	67.52	530	20.87	1700	66.93	490	19.29	1660	65.35	316	12.44	on request	on request	on request	on request	NO
AZ.HY 80 180 50	013290080	802	31.57	1800	70.87	2080	81.89	510	20.08	1	112	0,8933	4	689	27.13	1715	67.52	530	20.87	1700	66.93	490	19.29	1660	65.35	416	16.38	on request	on request	on request	on request	NO
AZ.HY 80 180 60	013290130	802	31.57	1800	70.87	2138	84.17	610	24.02	1	114	1,0982	4	689	27.13	1715	67.52	530	20.87	1700	66.93	490	19.29	1660	65.35	516	20.31	on request	on request	on request	on request	NO
AZ.HY 80 200 40	013290180	802	31.57	2000	78.74	2222	87.48	410	16.14	1	119	0,7672	4	689	27.13	1915	75.39	530	20.87	1900	74.8	490	19.29	1860	73.23	316	12.44	on request	on request	on request	on request	NO
AZ.HY 80 200 50	013290230	802	31.57	2000	78.74	2280	89.76	510	20.08	1	121	0,9792	4	689	27.13	1915	75.39	530	20.87	1900	74.8	490	19.29	1860	73.23	416	16.38	on request	on request	on request	on request	NO
AZ.HY 80 200 60	013290280	802	31.57	2000	78.74	2338	92.05	610	24.02	1	123	1,201	4	689	27.13	1915	75.39	530	20.87	1900	74.8	490	19.29	1860	73.23	516	20.31	on request	on request	on request	on request	NO
AZ.HY 100 180 40	013290040	1002	39.45	1800	70.87	2022	79.61	410	16.14	1	129	0,8722	4	889	35.00	1715	67.52	730	28.74	1700	66.93	690	27.17	1660	65.35	316	12.44	on request	on request	on request	on request	NO
AZ.HY 100 180 50	013290090	1002	39.45	1800	70.87	2080	81.89	510	20.08	1	133	1,1161	4	889	35.00	1715	67.52	730	28.74	1700	66.93	690	27.17	1660	65.35	416	16.38	on request	on request	on request	on request	NO
AZ.HY 100 180 60	013290140	1002	39.45	1800	70.87	2138	84.17	610	24.02	1	136	1,3721	4	889	35.00	1715	67.52	730	28.74	1700	66.93	690	27.17	1660	65.35	516	20.31	on request	on request	on request	on request	NO
AZ.HY 100 200 40	013290190	1002	39.45	2000	78.74	2222	87.48	410	16.14	1	140	0,9585	4	889	35.00	1915	75.39	730	28.74	1900	74.8	690	27.17	1860	73.23	316	12.44	on request	on request	on request	on request	NO
AZ.HY 100 200 50	013290240	1002	39.45	2000	78.74	2280	89.76	510	20.08	1	144	1,2234	4	889	35.00	1915	75.39	730	28.74	1900	74.8	690	27.17	1860	73.23	416	16.38	on request	on request	on request	on request	NO
AZ.HY 100 200 60	013290290	1002	39.45	2000	78.74	2338	92.05	610	24.02	1	146	1,5005	4	889	35.00	1915	75.39	730	28.74	1900	74.8	690	27.17	1860	73.23	516	20.31	on request	on request	on request	on request	NO
AZ.HY 120 180 40	013290050	1202	47.32	1800	70.87	2022	79.61	410	16.14	2	154	1,0463	4 per door	1089	42.87	1715	67.52	2x330	2x9.06	1700	66.93	2x290	2x11.42	1660	65.35	316	12.44	on request	on request	on request	on request	NO
AZ.HY 120 180 50	013290100	1202	47.32	1800	70.87	2080	81.89	510	20.08	2	158	1,3388	4 per door	1089	42.87	1715	67.52	2x330	2x9.06	1700	66.93	2x290	2x11.42	1660	65.35	416	16.38	on request	on request	on request	on request	NO
AZ.HY 120 180 60	013290150	1202	47.32	1800	70.87	2138	84.17	610	24.02	2	161	1,646	4 per door	1089	42.87	1715	67.52	2x330	2x9.06	1700	66.93	2x290	2x11.42	1660	65.35	516	20.31	on request	on request	on request	on request	NO
AZ.HY 120 200 40	013290200	1202	47.32	2000	78.74	2222	87.48	410	16.14	2	167	1,1498	4 per door	1089	42.87	1915	75.39	2x330	2x9.06	1900	74.8	2x290	2x11.42	1860	73.23	316	12.44	on request	on request	on request	on request	NO
AZ.HY 120 200 50	013290250	1202	47.32	2000	78.74	2280	89.76	510	20.08	2	170	1,4676	4 per door	1089	42.87	1915	75.39	2x330	2x9.06	1900	74.8	2x290	2x11.42	1860	73.23	416	16.38	on request	on request	on request	on request	NO
AZ.HY 120 200 60	013290300	1202	47.32	2000	78.74	2338	92.05	610	24.02	2	173	1,8	4 per door	1089	42.87	1915	75.39	2x330	2x9.06	1900	74.8	2x290	2x11.42	1860	73.23	516	20.31	on request	on request	on request	on request	NO

\*Net weight without packing material

# ACCESSORIES

## AS.HY\_AZ.HY / CABLE GLAND PLATES

Cable inlet plate made of AISI 304 stainless steel (Wnr 1.4301), suitable for applications with cable glands. Standard version with flat plate, replaceable on request with a clamp plate.

### FLAT CABLE GLAND PLATE

Model	Order no. flat cable gland plate kit
AS.HY / AZ.HY 60 40 AS.HY / AZ.HY 60 50	0134760030 0134760110
AS.HY / AZ.HY 80 40 AS.HY / AZ.HY 80 50	0134760040 0134760120
AS.HY / AZ.HY 100 40 AS.HY / AZ.HY 100 50	0134760050 0134760130
AS.HY / AZ.HY 120 40 AS.HY / AZ.HY 120 50	0134760060 0134760140



### DOUBLE CABLE GLAND PLATE

Model	Order no. double cable gland plate kit
AS.HY / AZ.HY 60 40 AS.HY / AZ.HY 60 50	0134760330 0134760410
AS.HY / AZ.HY 80 40 AS.HY / AZ.HY 80 50	0134760340 0134760420
AS.HY / AZ.HY 100 40 AS.HY / AZ.HY 100 50	0134760350 0134760430
AS.HY / AZ.HY 120 40 AS.HY / AZ.HY 120 50	0134760360 0134760440



## AS.HY\_AZ.HY / EXTERNAL EQUIPMENT

### FEET PLINTH AND PLINTH PLUS HYGIENIC FEET

ORDER NO.	DESCRIPTION	DIMENSIONS
013285010	PLINTH+FEET.HY	40 40
013285020	PLINTH+FEET.HY	60 40
013285030	PLINTH+FEET.HY	80 40
013285040	PLINTH+FEET.HY	100 40
013285050	PLINTH+FEET.HY	120 40
013285060	PLINTH+FEET.HY	40 50
013285070	PLINTH+FEET.HY	60 50
013285080	PLINTH+FEET.HY	80 50
013285090	PLINTH+FEET.HY	100 50
013285100	PLINTH+FEET.HY	120 50
013285110	PLINTH+FEET.HY	40 60
013285120	PLINTH+FEET.HY	60 60
013285130	PLINTH+FEET.HY	80 60
013285140	PLINTH+FEET.HY	100 60
013285150	PLINTH+FEET.HY	120 60
013285200	BASE+FEET	40 40
013285210	BASE+FEET	60 40
013285220	BASE+FEET	80 40
013285230	BASE+FEET	100 40
013285240	BASE+FEET	120 40
013285250	BASE+FEET	40 50
013285260	BASE+FEET	60 50
013285270	BASE+FEET	80 50
013285280	BASE+FEET	100 50
013285290	BASE+FEET	120 50
013285300	BASE+FEET	40 60
013285310	BASE+FEET	60 60
013285320	BASE+FEET	80 60
013285330	BASE+FEET	100 60
013285340	BASE+FEET	120 60

